



350 S. St. Charles St. Jasper, In. 47546  
Ph. 812.482.2932 Fax 812.634.6632

[www.ridetech.com](http://www.ridetech.com)

**Part # 11012899**  
**55-57 Chevy Car Lower StrongArms**  
For Use with Shockwaves or CoilOvers

**Components:**

1	90000561	Driver side lower control arm
1	90000562	Passenger side lower control arm
2	90000916	Lower ball joint (includes boots, castle nuts and cotter pins)
4	90000906	Lower control arm bushing
2	90002694	Lower Cross shafts
4	90002062	Aluminum spacers for Shockwaves

**Hardware:**

2	99501024	½"-13 x 3 ¼" Gr. 5 bolt	ShockWave to lower arm
2	99502001	½"-13 Nylok nut	ShockWave to lower arm

# STRONG<sup>ARMS</sup><sup>TM</sup>

by Air Ride Technologies

## Installation Instructions



1. Remove the OEM controls are from the car.

2. Bolt the lower StrongArm to the car using the oem bolts. Note that the sway bar mount will face toward the front of the vehicle.

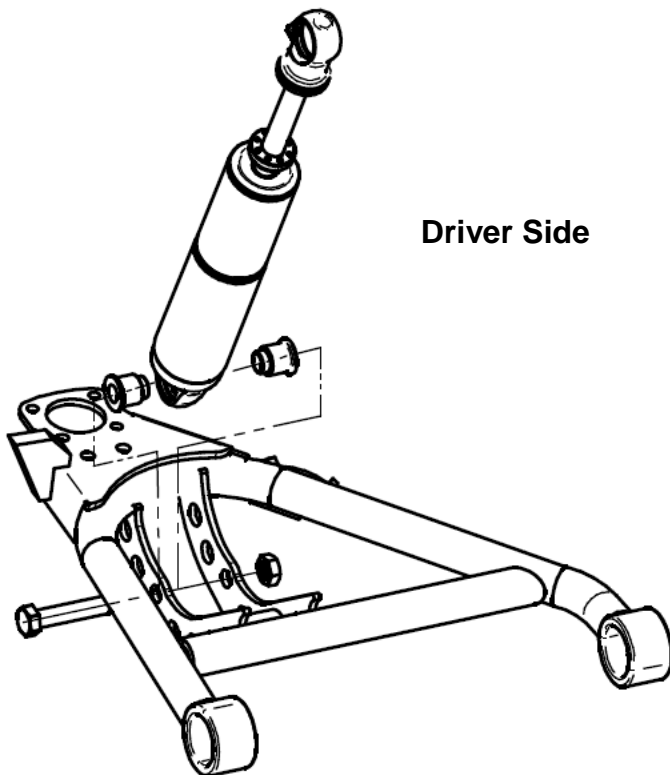

3. Bolt the Shockwave or CoilOver to the lower arm using the supplied 1/2" x 3 1/4" bolt and Nylok. An aluminum spacer on both sides of the eye will center the Shockwave.

**Note:** There are holes on the lower arm near the ball joint to mount the factory bump stop. Although, it is not needed unless you are having tire clearance issues.

4. Slide the ball joint through the spindle and secure w/ castle nut and cotter pin.

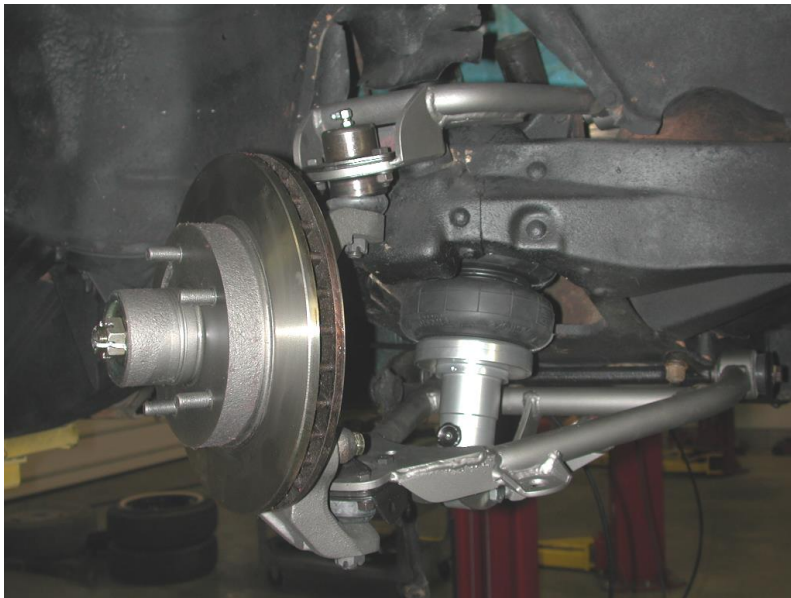

5. Grease the ball joints.

6. Double check air spring clearance through full suspension travel. If any part of the Shockwave touches the frame at anytime it will damage the unit. **This is not a warrantable situation.**

Item #	Description	Qty.
1.	Passenger side arm	1
1.	Driver side arm	1
2.	Aluminum bearing spacer	4
3.	1/2"-13 x 3 1/4" bolt	2
4.	1/2"-13 Nylok nut	2
5.	Cross shaft bushing	4
6.	Ball joint	2
7.	5/16"-24 nut	8
8.	5/16"-24 x 3/4" bolt	8

