

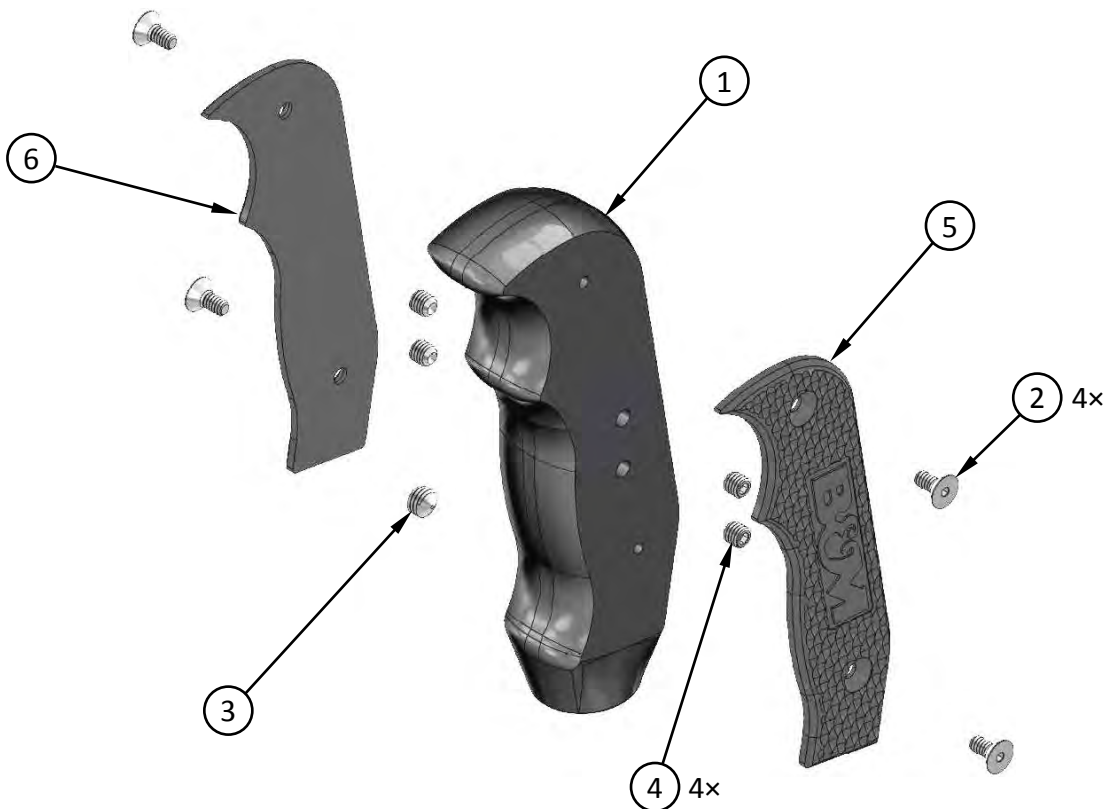

Installation Instructions
**B&M MAGNUM GRIP
SHIFTER HANDLE**

2016-20 YAMAHA YXZ1000R

Catalog No. (Grip Color): 81209 (Black);
81210 (Blue); 81211 (Green); 81212 (Orange);
81213 (Red); 81214 (White); 81215 (Yellow)



REFER TO PARTS LIST ON NEXT PAGE



Installation Instructions B&M MAGNUM GRIP SHIFTER HANDLE

2016-20 YAMAHA YXZ1000R

Catalog No. (Grip Color): 81209 (Black);
81210 (Blue); 81211 (Green); 81212 (Orange);
81213 (Red); 81214 (White); 81215 (Yellow)

PARTS LIST

ITEM NO.	PART NO.	DESCRIPTION	QTY.
1	4001722	MAGNUM GRIP SHIFTER HANDLE BODY	1
2	3401537	SCREW, SOCKET, FLAT HEAD, 6-32 × 5/16", STAINLESS	4
3	3401544	SET SCREW, CONE POINT, 1/4-28 × 3/16", 18-8 SS	1
4	3401545	SET SCREW, CUP POINT, 10-32 × 3/16", 18-8 SS	4
5	4001492	MAGNUM GRIP SHIFTER PLATE, LEFT, DIAMOND KNURL – BLACK	1
	4001724	" " " " " " " " – BLUE	
	4001732	" " " " " " " " – GREEN	
	4001730	" " " " " " " " – ORANGE	
	4001726	" " " " " " " " – RED	
	4001734	" " " " " " " " – WHITE	
	4001728	" " " " " " " " – YELLOW	
6	4001495	MAGNUM GRIP SHIFTER PLATE, RIGHT, DIAMOND KNURL – BLACK	1
	4001725	" " " " " " " " – BLUE	
	4001733	" " " " " " " " – GREEN	
	4001731	" " " " " " " " – ORANGE	
	4001727	" " " " " " " " – RED	
	4001735	" " " " " " " " – WHITE	
	4001729	" " " " " " " " – YELLOW	

Before starting, take a moment to read and understand these instructions for your B&M Magnum Grip Shifter Handle. Use the parts drawing and list to verify your kit's contents. In the unlikely event of missing parts, please contact B&M Racing Technical Support for replacements. Direct all correspondence and warranty questions to:

We highly recommend that you retain all factory parts.

1. Turn off your vehicle's ignition and set the parking brake.



2. Remove the fastener from the right side of the shifter handle.



3. Pull the shifter handle off the shifter lever.



4. Thread the 4 small set screws (Item 4) about halfway into the shifter handle body (1) (two screws each side). Thread the large set screw (3) about halfway into the right side of the shifter handle body.



5. Slide the shifter handle body all the way onto the shifter lever.



6. Tighten all five set screws to secure the shifter handle to the shifter lever.



7. Install the left and right side plates (5) and (6) with the four flathead screws (2).

Congratulations, the installation of your B&M Magnum Grip Shifter Handle is now complete!